



The Safe Choice

LKC-2 Non-return Valve

Application

Non-return valve LKC-2 is designed for use in stainless steel pipe installations to prevent reverse flow.

Working principle

LKC-2 opens when the pressure below the valve plug exceeds the pressure above the plug and the spring force.

The valve closes when pressure equalization has been achieved. A higher counter pressure will press the valve plug against the seat.

Standard Design

The valve body is in two parts, assembled by means of a clamp ring and hygienically sealed with a special seal ring. A guide disc and four legs guide the spring loaded valve plug with an O-ring seal. LKC-2 has welding ends for ISO or DIN connections.

Materials

Steel parts:Stainless steel 1.4301
(304) or acid-resistant steel
1.4404 (316L).
Seal rings:EPDM rubber.
Finish:Semi bright.

Connections

The valve is available with welding ends for tubes according to ISO and DIN 11850.

Technical data

Required differential pressure for opening the valve when fitted in a vertical pipe, as shown in fig. 3, is approx. 6 kPa (0.06 bar).

Max. product pressure:1000 kPa (10 bar).
Max. temperature:140°C (EPDM).
Min. temperature:-10°C.



LKC-2, non-return valve.

Option

Product wetted seal rings of Nitrile (NBR) or Fluorinated rubber (FPM).

Ordering

Please state the following when ordering:

- Size.
- Steel grade, 1.4301 (304) or 1.4404 (316L).
- Connections, if not welding ends.
- Rubber grade if not EPDM.

Pressure drop/capacity diagram

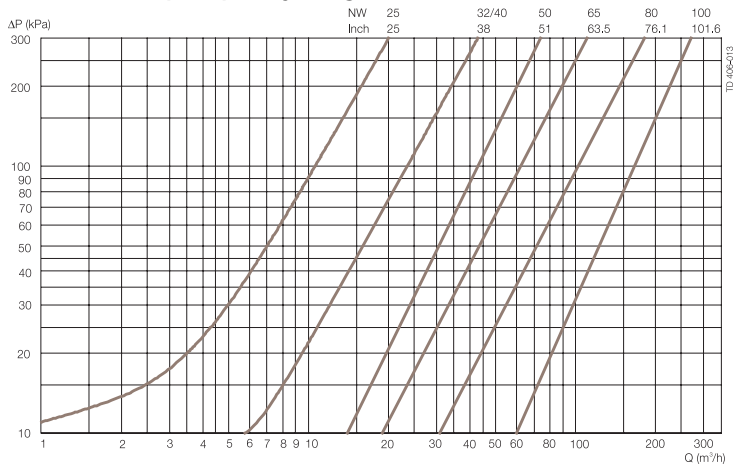

Fig.1. **Note!**

For the diagram the following applies:

Medium: Water (20°C).

Measurement: In accordance with VDI 2173.

Dimensions (mm)

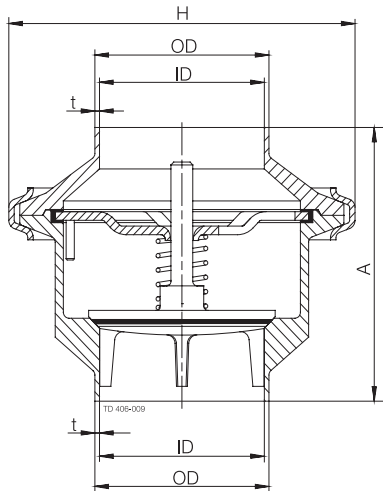

Fig. 2. Dimensions.

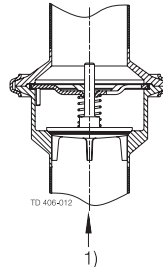

Fig.3 1 = Flow direction.

Shows the optimal built-in situation. Other positions possible are e.g. horizontal. The four guide legs of the valve cone ensures good alignment. 90° rotation.

Size	25	38	51	63.5	76.1	101.6	DN	DN	DN	DN	DN	DN	DN
	mm	mm	mm	mm	mm	mm	25	32	40	50	65	80	100
A	62.5	75.0	87.5	95.0	115	155	62.5	75.0	75.0	87.5	95.0	115	155
OD	25.4	38.4	51.4	63.9	76.4	102	30.0	36.0	42.0	54.0	70.0	85.0	104
ID	22.5	35.5	48.5	60.5	72.0	97.6	26.0	32.0	38.0	50.0	66.0	81.0	100
t	1.45	1.45	1.45	1.7	2.2	2.2	2	2	2	2	2	2	2
H	72.0	85.5	99	127	138	164	72.0	85.5	85.5	99	127	138	164
Weight (kg)	0.5	0.7	1.0	1.7	2.4	4.3	0.5	0.7	0.7	1.0	1.7	2.4	4.3

ESE00294EN 1001

The information contained herein is correct at the time of issue, but may be subject to change without prior notice.

How to contact Alfa Laval

Contact details for all countries are continually updated on our website. Please visit www.alfalaval.com to access the information direct.