

RM-MS Multistage, magnetically coupled centrifugal pump

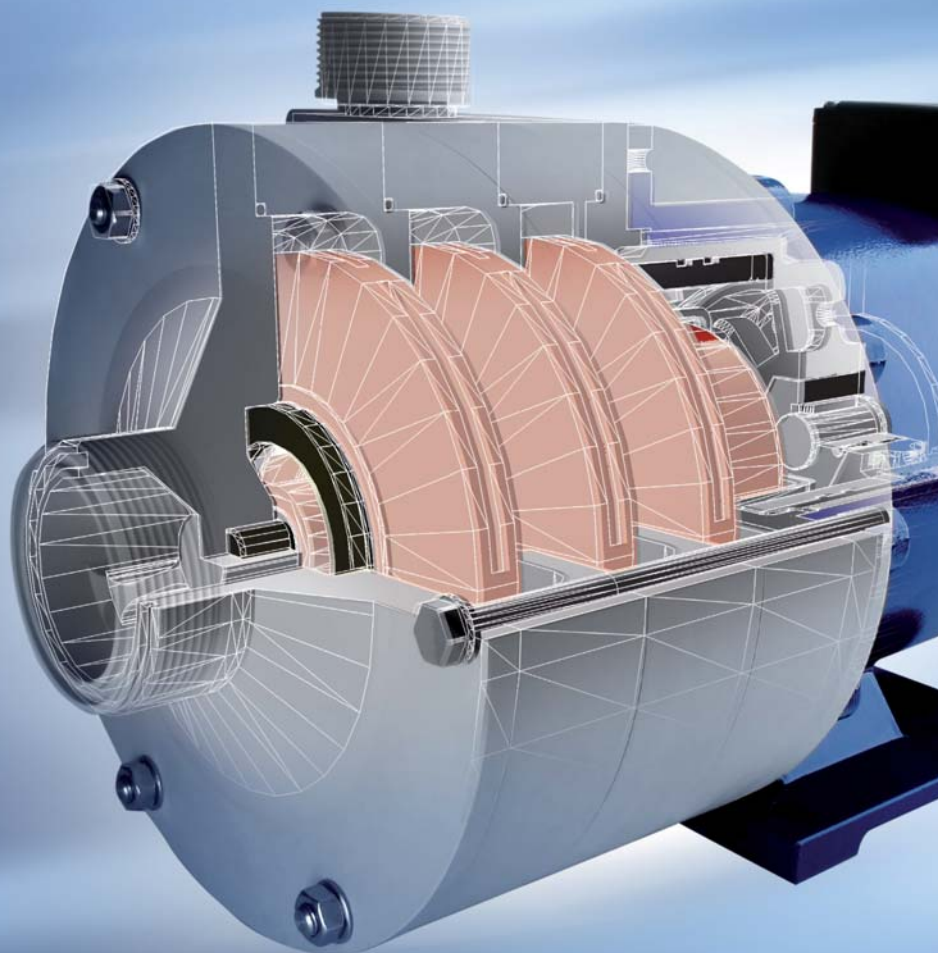

RM-MS, efficient
pumping of chemicals
with high pressure.

1959-2009
50
YEARS
SONDERMANN
PUMPS + FILTERS



SONDERMANN
PUMPEN + FILTER GMBH & Co. KG

Competence in pump
and filter technologies

Increased efficiency in high pressure applications with multistage, magnetically coupled pump RM-MS.

The advantages of type RM-MS at a glance:

- ▶ Energy efficient in high pressure operation
- ▶ Flexible and modular design
- ▶ Multistage with 1, 2, or 3 impeller
- ▶ Driven by magnetic coupling
- ▶ Best hydraulic efficiency
- ▶ Environment friendly by hermetically sealed pump housing
- ▶ Best chemical resistance
- ▶ Metal-free design made of PP or PVDF

Performance charts type RM-MS

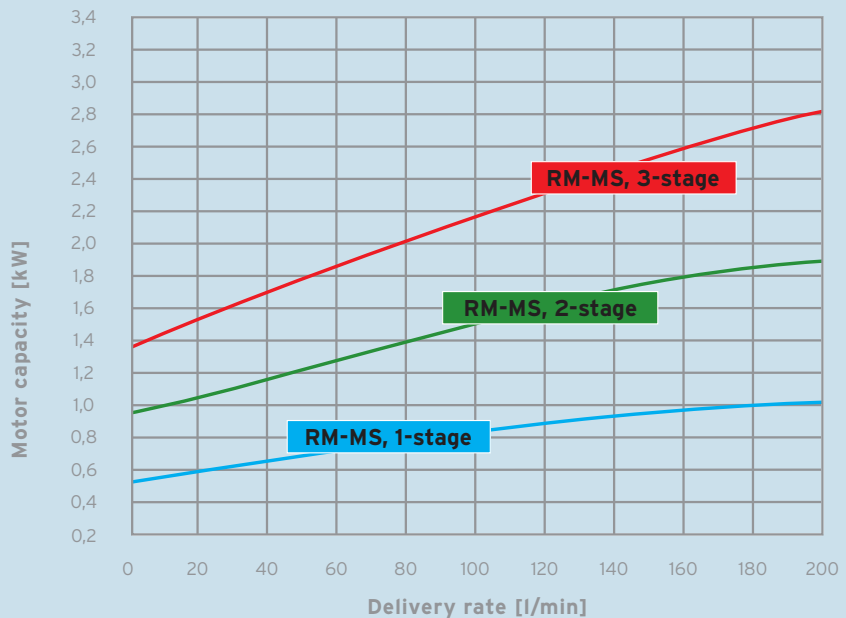
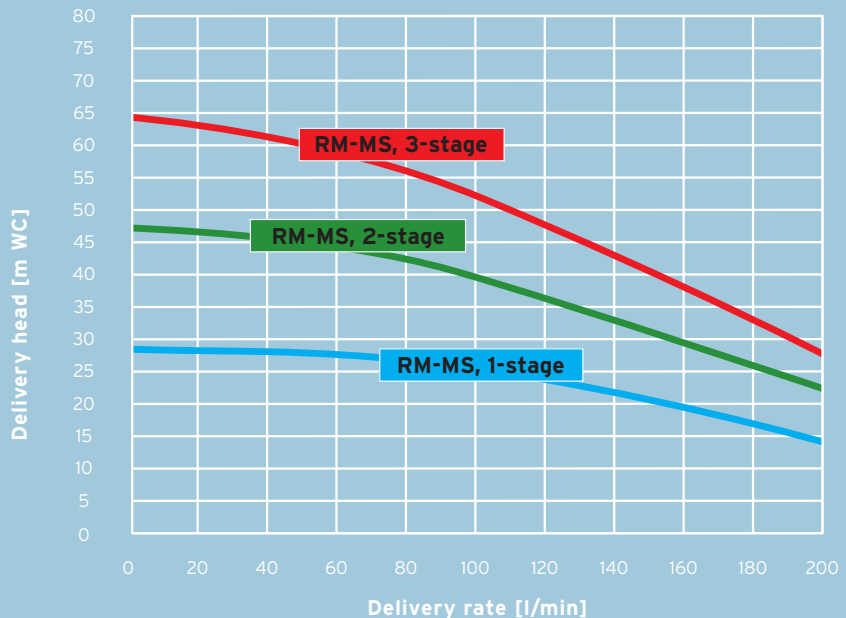

In high pressure applications singlestage centrifugal pumps are not very efficient. For operation in high pressure ranges multistage centrifugal pumps are required. That is to say, multiple centrifugal pumps respectively impellers are connected in series. In series connection the delivery heights will add together. In high pressure ranges the type RM-MS will reach a higher efficiency than a singlestage centrifugal pump for higher delivery rates, which works in unfavourable operational area.





NEW!

Technical data

size	RM-MS, 1-stage	RM-MS, 2-stage	RM-MS, 3-stage
maximum delivery rate [l/min]	200	200	200
maximum delivery head [m WC]	28	47	65
motor capacity [kW]	0,75 - 3,0		
voltage at 50 Hz [V]	220 - 240 / 380 - 415		
voltage at 60 Hz [V]	255 - 277 / 440 - 480		
protection class	IP 55		
connections	suction side G 2 1/4	pressure side G 1 1/2	
materials	PP	PVDF	
max. temperature [° C]	80	90	
max. system pressure at 20° C [bar]	8,0	8,0	

Types and sizes

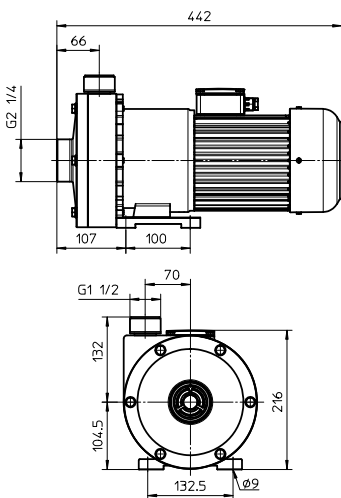

RM-MS, 1-stage
1,5 kW

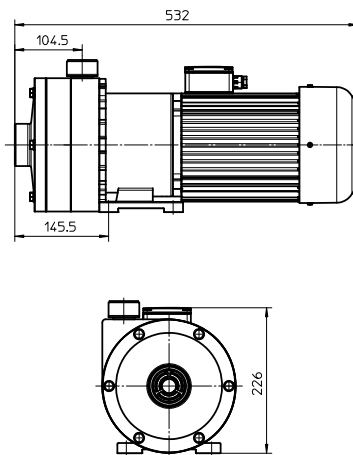

RM-MS, 2-stage
2,2 kW

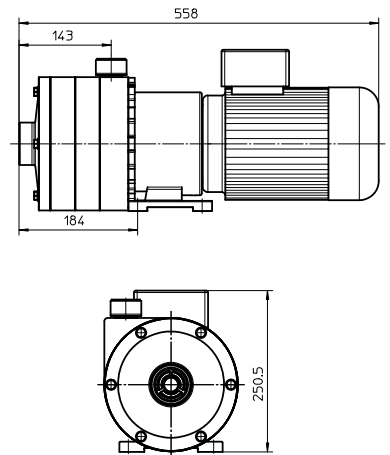

RM-MS, 3-stage
3,0 kW

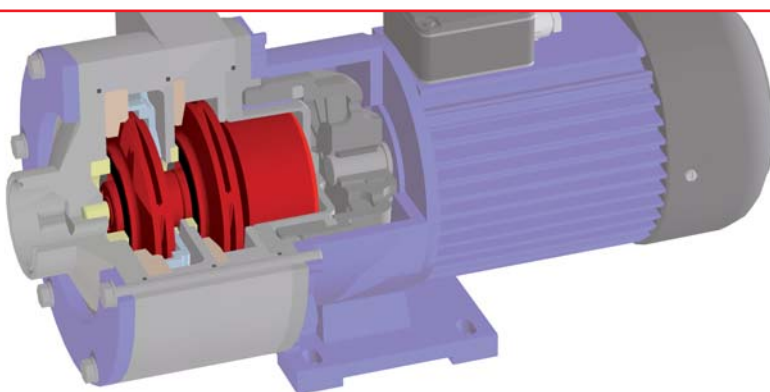

Competence in pump and filter technology. This means excellent product quality, reliable service and long-standing experience. And this since 50 years.



SONDERMANN
PUMPEN + FILTER GMBH & Co. KG

Sondermann's RPR Control-100 for electronic process monitoring of pumps.

1959-2009
50
YEARS
SONDERMANN
PUMPEN + FILTERS



Separate programming unit
Hand-held programmer with
cable and plug to programme
specific switching thresholds
to RPR Control-100 1 and
100 3 systems

Users of centrifugal pumps are only too well aware of the problem that most pumps do not fail because of progressive wear but, long before their end of life, due to critical operating conditions like dry running, overheating or operation in cavitation.

The active-power meter integrated to the RPR Control-100 system has 4 user-programmable switching thresholds assigned to the following operating conditions:

- ▶ Dry running
- ▶ Overheating
- ▶ Overload
- ▶ Flow rate falling below minimum value



RPR Control-100 1
to be built into control
cabinets and plug in the
separate programming unit
(mounted on top-hat rail)



Portable RPR Control-100 3
with indicating lamps
and push-buttons but
without programming
unit



RPR Control-100 2
to be built into control
cabinets with integrated
programming unit
(mounted on top-hat rail)

Our product specialists will be glad to help you. Please
take contact to your personal adviser - by phone or eMail:

 **+49.2203.9394-0**

rm-ms@sondermann-pumpen.de



SONDERMANN
PUMPEN + FILTER GMBH & Co. KG

Sondermann Pumpen + Filter
GmbH & Co. KG

August-Horch-Straße 4, D-51149 Cologne

Tel. +49.2203.9394-0

Fax +49.2203.9394-48

info@sondermann-pumpen.de

www.sondermann-pumpen.de